



Escambia County Building Inspections Division  
3300 N. Pace Blvd., Suite 300  
Pensacola, FL 32505  
Telephone: (850) 595-3550 Facsimile: (850) 595-3589  
On the Web: [www.myescambia.com](http://www.myescambia.com)

## LAWN STORAGE SHEDS

# Standard Details for Wood Framed Sheds

Index to Drawings	
Description	Drawing No.
Cover Sheet	C-1
General Notes	G-1
Foundation Plan (Option 1)	A-1
Wall Section	A-2
Enlarged Details	A-3
Floor Framing Plan (Option 2)	A-4
Cable Tie Down Details	A-5
Floor Framing	A-6
Wall Framing	A-7
Framing at Door Opening	A-8
Framing at Window Opening - Sidewall	A-9
Framing at Window Opening - Endwall	A-10
Connector Details	A-11
Ridge Beam and Collar Beam Details	A-12
Roof Framing Plan	A-13
Nailing Pattern	A-14

Wood Framed Sheds

Cover Sheet

Dwg. Number:

C-1

# General Notes

1. Prescriptive design parameters are according to The Wood Frame Construction Manual 2001 Edition under the provisions of section 1606.1.1, paragraph (4) of the Florida Building Code - 2001 Edition.
2. Wall sheathing shall be exterior grade wood structural panel with a minimum thickness of ½ inch if installed horizontally with long dimension on vertical studs or a minimum thickness of 19/32 inch if installed vertically on studs.
3. Exterior wall vapor barrier, siding or finish is optional.
4. Wall studs spacing shall not exceed 24" on center.
5. Window openings are optional, locations are at the center of the wall. Width of window opening shall not exceed 4 ft.
6. Header lumber for window and door openings up to 4 ft wide shall be made of 2-2"x 4".
7. Jack studs to support headers on window and door openings up to 4ft wide shall be made of 1-2" x 4" located at each end of the header.
8. Roof rafter spacing shall not exceed 24" on center.
9. Collar ties (collar beams) of nominal 2"x 4" lumber shall be located in the upper third of the attic space and attached to rafters with a minimum of 2-10d common nails at each end.
10. Roof sheathing shall be a minimum of 7/16" thick of wood structural panel and shall be installed with the long dimension across the rafter supports. Edges of all 7/16 inch roof structural panel supported at 24" on center, shall be supported with blocking or edge clips.
11. Roof structural panel shall be attached to supports with 8d common nails or 10d box nails and spacing shall not exceed 6" on center.
12. Roofing material, windows and doors shall have a Florida product approval and shall be installed according to manufacturer's specifications.

Wood Framed Sheds	General Notes	Dwg. Number:	G-1
-------------------	---------------	--------------	-----

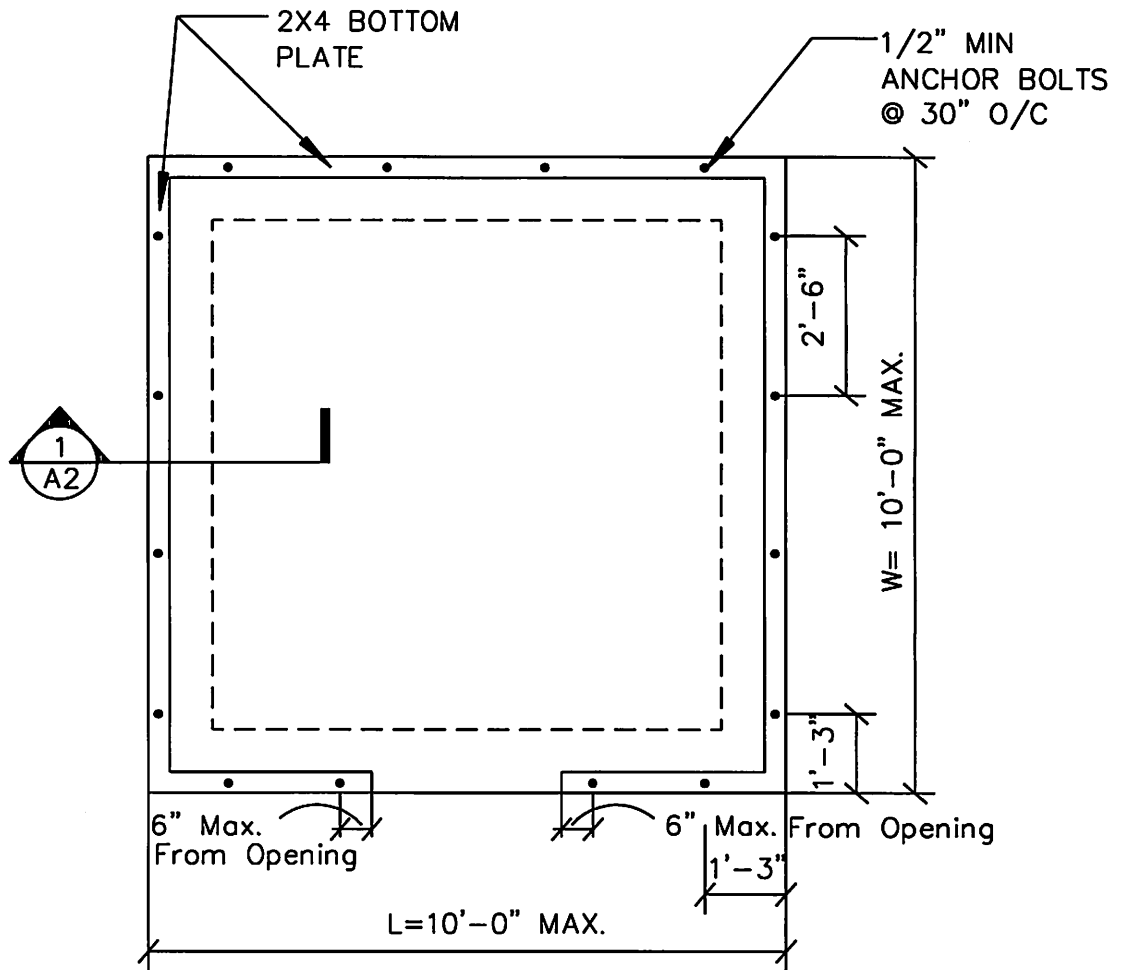

THIS DETAIL IS IN COMPLIANCE WITH THE WIND LOAD PROVISIONS FOR 120 MPH OF THE PRESCRIPTIVE DESIGN OF THE WOOD FRAME CONSTRUCTION MANUAL (WFMC) 2001 EDITION

WOOD FRAMED  
SHEDS

OPTION 1  
SLAB ON GRADE  
FOUNDATION PLAN

DETAIL NUMBER:		A-1	
SPEC. NUMBER:		45MM	
SCALE:		3/8"=1'-0"	
DATE:	12/14/04	REVISION DATE:	3/15/05
DRAWN BY:	ANGEL	APPROVED BY:	

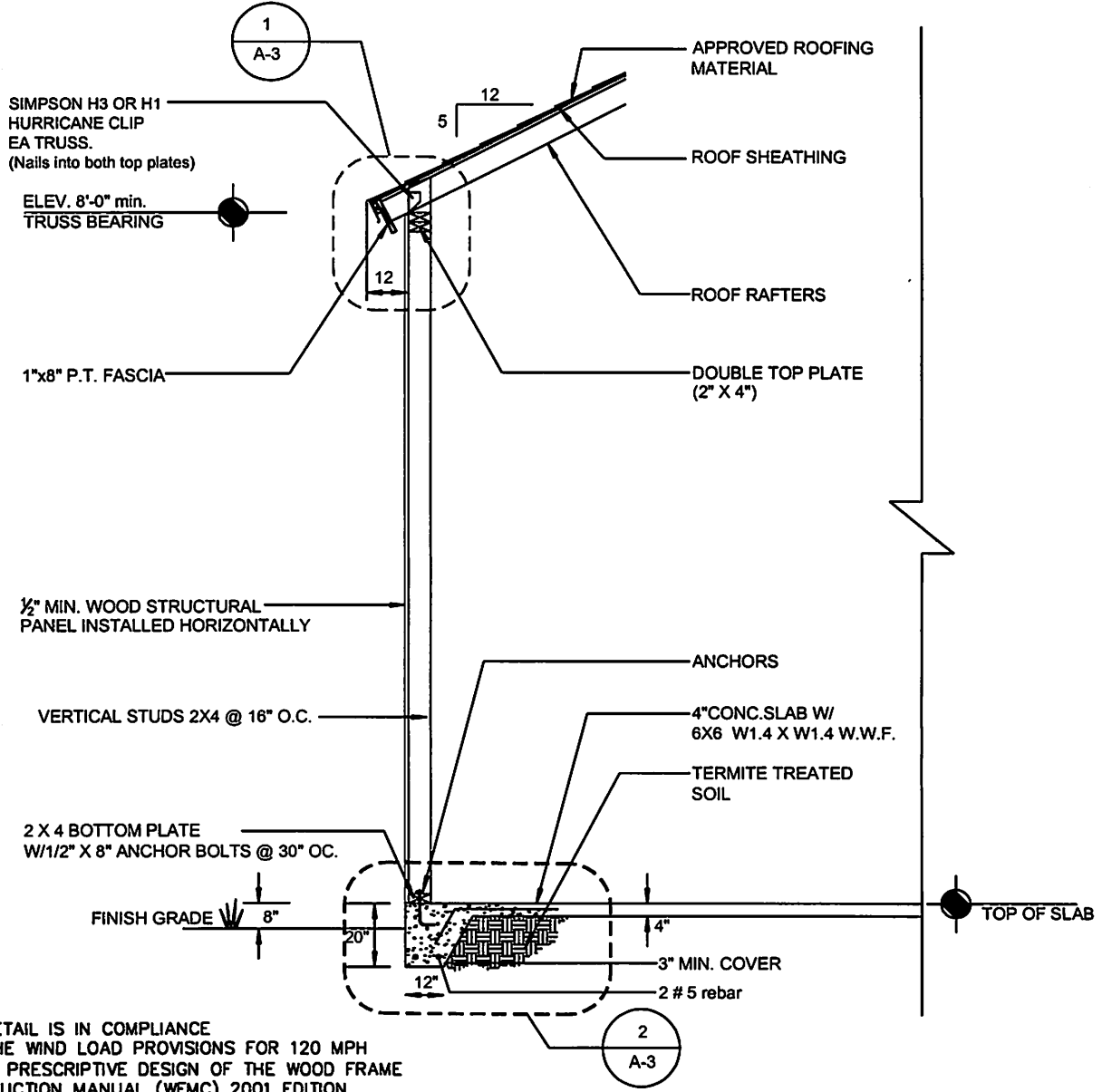

# STANDARD DETAIL

1  
A-2

SCALE= 1/4"=1'-0"

WOOD FRAMED SHEDS	STANDARD DETAIL	DETAIL NUMBER: A-2
	WALL SECTION	SPEC. NUMBER: 45MM
		SCALE: 1/4"=1'-0"
		DATE: 12/14/04      REVISION DATE: 3/15/05
		DRAWN BY: ANGEL      APPROVED BY:

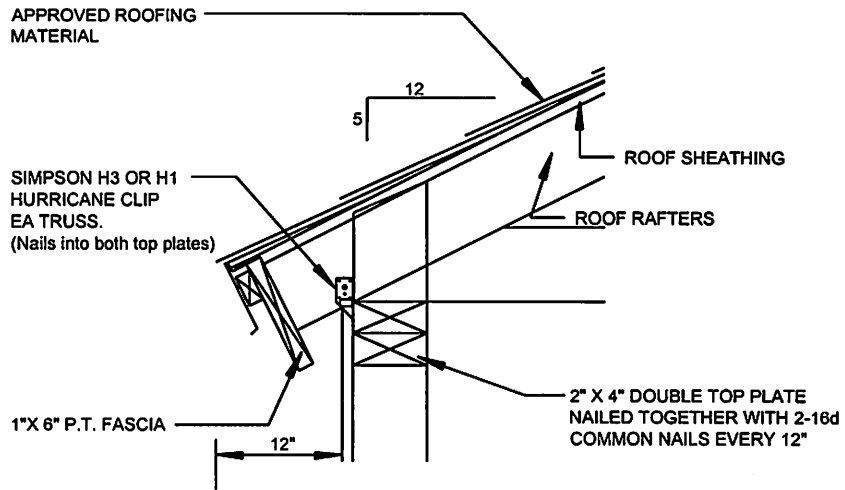

1 WALL TO ROOF DETAIL  
A-3 SCALE= 3/4"=1'-0"

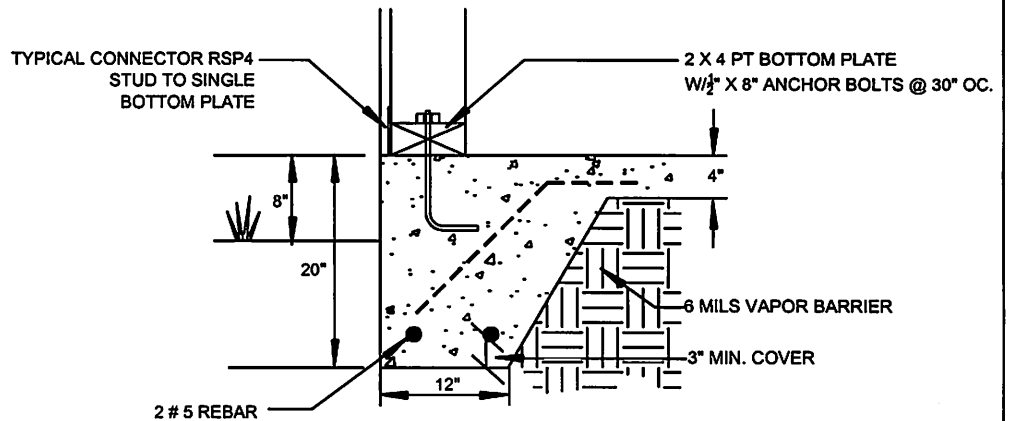

2 FOUNDATION DETAIL  
A-3 SCALE= 3/4"=1'-0"

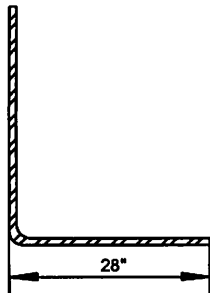

4 STANDARD HOOKS FOR #5 BAR  
A-3 SCALE= 3/4"=1'-0"

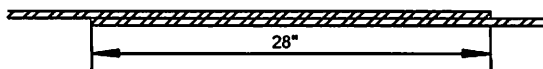

3 SPLICE DETAIL FOR #5 BAR  
A-3 SCALE= 3/4"=1'-0"

THIS DETAIL IS IN COMPLIANCE WITH THE WIND LOAD PROVISIONS FOR 120 MPH OF THE PRESCRIPTIVE DESIGN OF THE WOOD FRAME CONSTRUCTION MANUAL (WFMC) 2001 EDITION

WOOD FRAMED SHEDS

STANDARD DETAILS

ENLARGED DETAIL

DETAIL NUMBER:	A-3	
SPEC. NUMBER:	45MM	
SCALE:	3/4"=1'-0"	
DATE:	12/14/04	REVISION DATE:
DRAWN BY:	ANGEL	APPROVED BY:

5/8" WOOD STRUCTURAL PANEL ON FLOOR  
 NAILED TO FLOOR JOIST AND BLOCKING WITH  
 8d COMMON NAILS

2"x4" TYPICAL BLOCKING UNDERNEATH  
 PLYWOOD JOINTS NAILED TO  
 FLOOR JOIST WITH 2-16d  
 COMMON NAILS

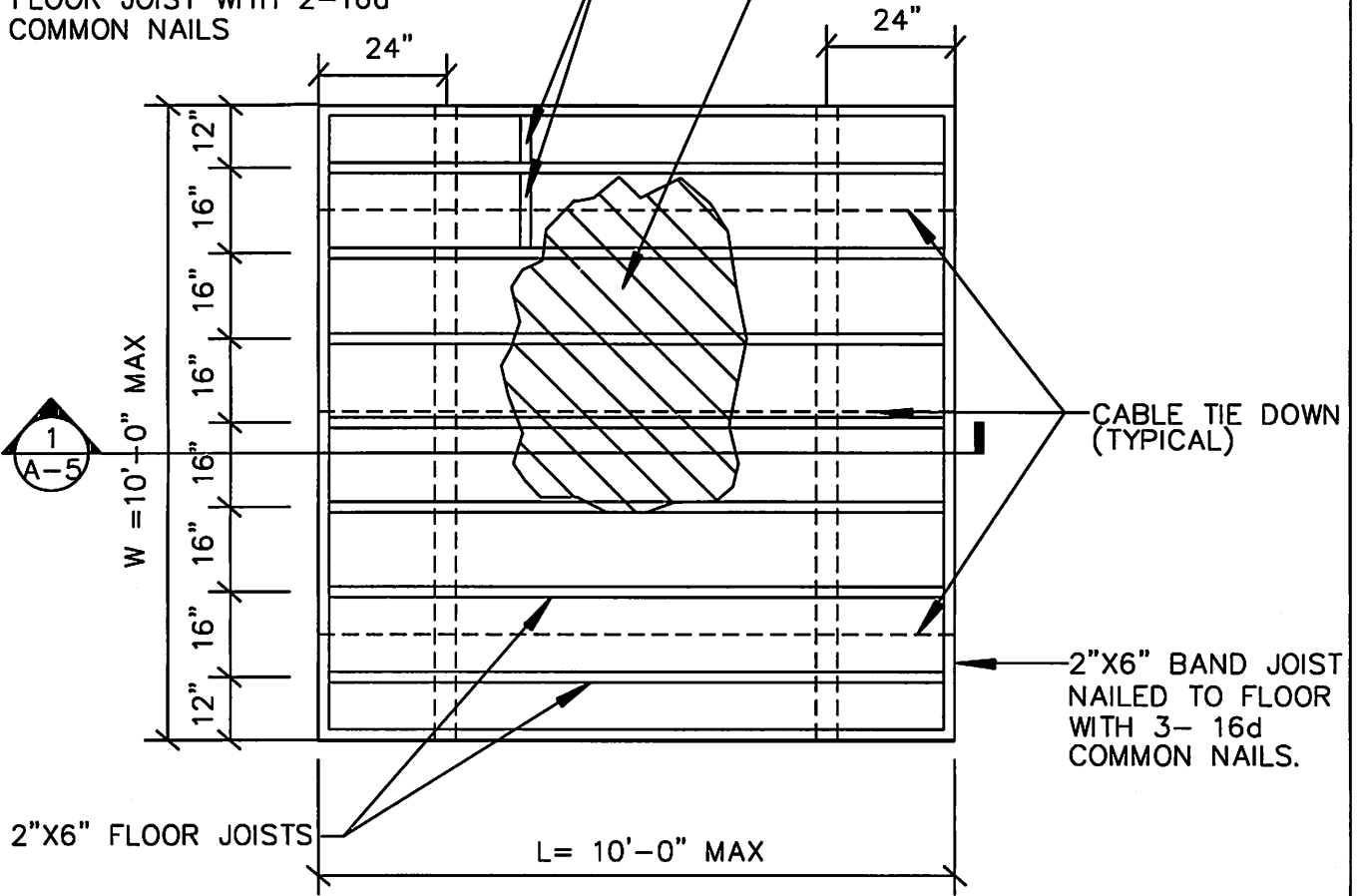

CABLE TIE DOWN  
 (TYPICAL)

2"x6" BAND JOIST  
 NAILED TO FLOOR  
 WITH 3- 16d  
 COMMON NAILS.

THIS DETAIL IS IN COMPLIANCE  
 WITH THE WIND LOAD PROVISIONS FOR 120 MPH  
 OF THE PRESCRIPTIVE DESIGN OF THE WOOD FRAME  
 CONSTRUCTION MANUAL (WFMC) 2001 EDITION

WOOD FRAMED  
 SHEDS

OPTION 2  
 FLOOR FRAMING PLAN

DETAIL NUMBER:		A-4
SPEC. NUMBER:		45MM
SCALE:		3/8"=1'-0"
DATE:	12/14/04	REVISION DATE:
		3/15/05
DRAWN BY:	APPROVED BY:	
ANGEL		

WOOD FRAMED  
SHEDS

CABLE TIE DOWN

DETAIL NUMBER: A-5	SPEC. NUMBER: A-5	SCALE: 1/2" = 1'-0"	DATE: 12/14/04	APPROVED BY: ANGEL
		REVISION DATE: 3/15/05		

OPTION 2  
FLOOR FRAMING DETAIL

3 (OPTION A)  
SCALE = 1-1/2" = 1'-0"

3 (OPTION B)  
SCALE = 1-1/2" = 1'-0"

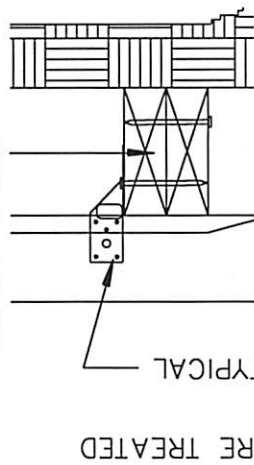
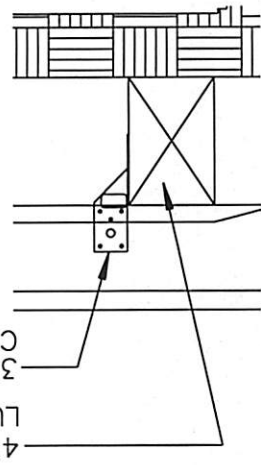

4"X6" PRESSURE TREATED LUMBER  
3H SIMPSON TYPICAL CONNECTOR  
WOOD NAILED TOGETHER WITH 2-16d COMMON NAILS EVERY 12"

2  
SCALE = 1" = 1'-0"

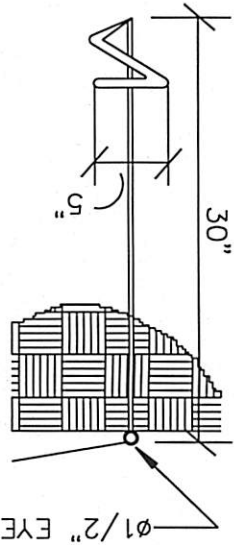

1  
SCALE = 1/2" = 1'-0"

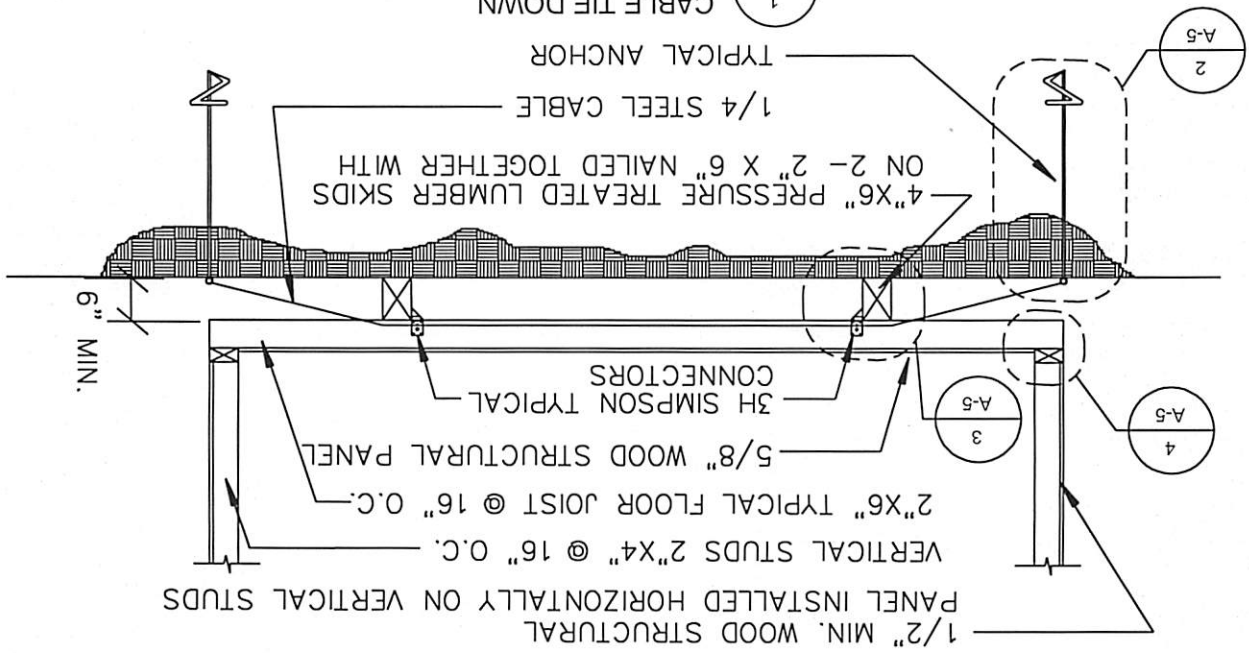

1/2" MIN. WOOD STRUCTURAL PANEL INSTALLED HORIZONTALLY ON VERTICAL STUDS  
VERTICAL STUDS 2"X4" @ 16" O.C.  
2"X6" TYPICAL FLOOR JOIST @ 16" O.C.  
5/8" WOOD STRUCTURAL PANEL  
3H SIMPSON TYPICAL CONNECTORS

4"X6" PRESSURE TREATED LUMBER SKIDS ON 2-2" X 6" NAILED TOGETHER WITH 1/4" STEEL CABLE

TYPICAL ANCHOR

6" MIN.

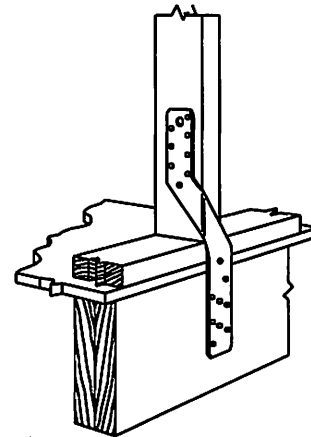

2" X 4" TYPICAL VERTICAL STUDS  
@16" O.C.



16 FASTENERS 8d COMMON NAILS

**(H6) STUD TO BAND JOIST**



SCALE= N.T.S.

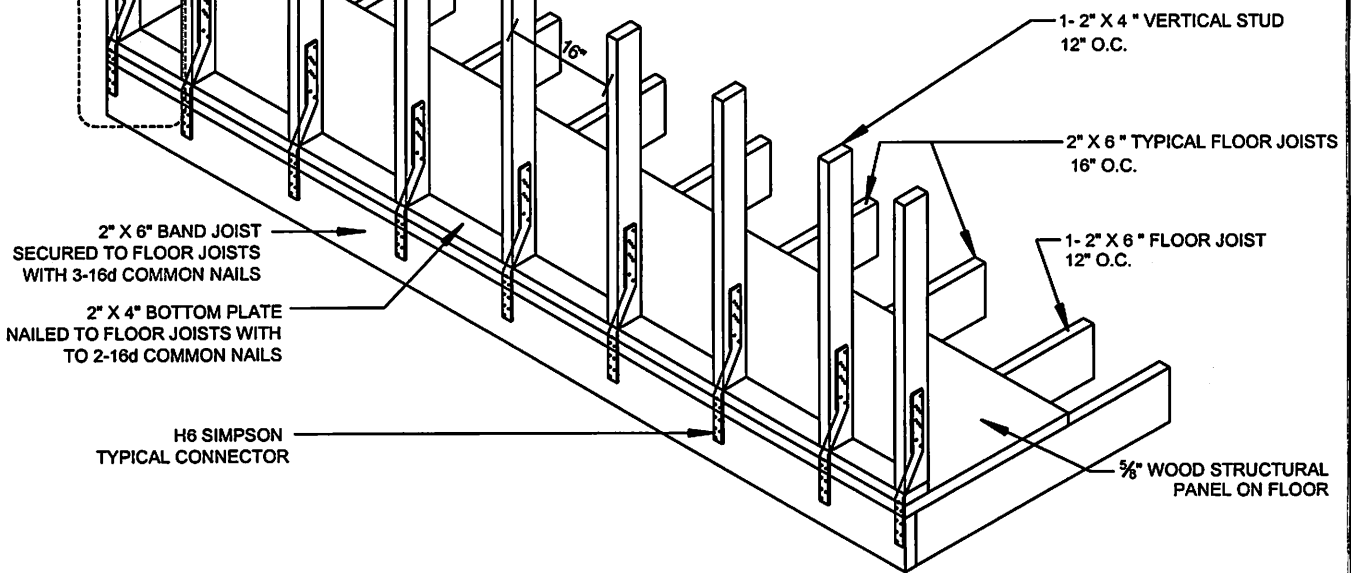

2" X 6" BAND JOIST  
SECURED TO FLOOR JOISTS  
WITH 3-16d COMMON NAILS

2" X 4" BOTTOM PLATE  
NAILED TO FLOOR JOISTS WITH  
TO 2-16d COMMON NAILS

H6 SIMPSON  
TYPICAL CONNECTOR

1- 2" X 4" VERTICAL STUD  
12" O.C.

2" X 6" TYPICAL FLOOR JOISTS  
16" O.C.

1- 2" X 6" FLOOR JOIST  
12" O.C.

5/8" WOOD STRUCTURAL  
PANEL ON FLOOR

THIS DETAIL IS IN COMPLIANCE  
WITH THE WIND LOAD PROVISIONS FOR 120 MPH  
OF THE PRESCRIPTIVE DESIGN OF THE WOOD FRAME  
CONSTRUCTION MANUAL (WFMC) 2001 EDITION

WOOD FRAMED  
SHEDS

STANDARD DETAIL  
FLOOR FRAMING

DETAIL NUMBER: A-6	
SPEC. NUMBER: 45MM	
SCALE: 3/8"=1'-0"	
DATE: 12/14/04	REVISION DATE: 3/15/05
DRAWN BY: ANGEL	APPROVED BY:



SIM 2  
1  
A-10

FULL HEIGHT  
STUD

TYPICAL RSP4  
STUD TO SINGLE  
BOTTOM PLATE

DOUBLE TOP  
PLATE

TYPICAL RSP4 CONNECTOR STUD TO  
DOUBLE TOP PLATE

4  
A-10

3  
A-10

THIS DETAIL IS IN COMPLIANCE  
WITH THE WIND LOAD PROVISIONS FOR 120 MPH  
OF THE PRESCRIPTIVE DESIGN OF THE WOOD FRAME  
CONSTRUCTION MANUAL (WFMC) 2001 EDITION

WOOD FRAMED  
SHEDS

STANDARD DETAIL

WALL FRAMING

DETAIL NUMBER:		A-7	
SPEC. NUMBER:		45MM	
SCALE: 3/8"=1'-0"			
DATE:	12/14/04	REVISION DATE:	3/15/05
DRAWN BY:	ANGEL	APPROVED BY:	

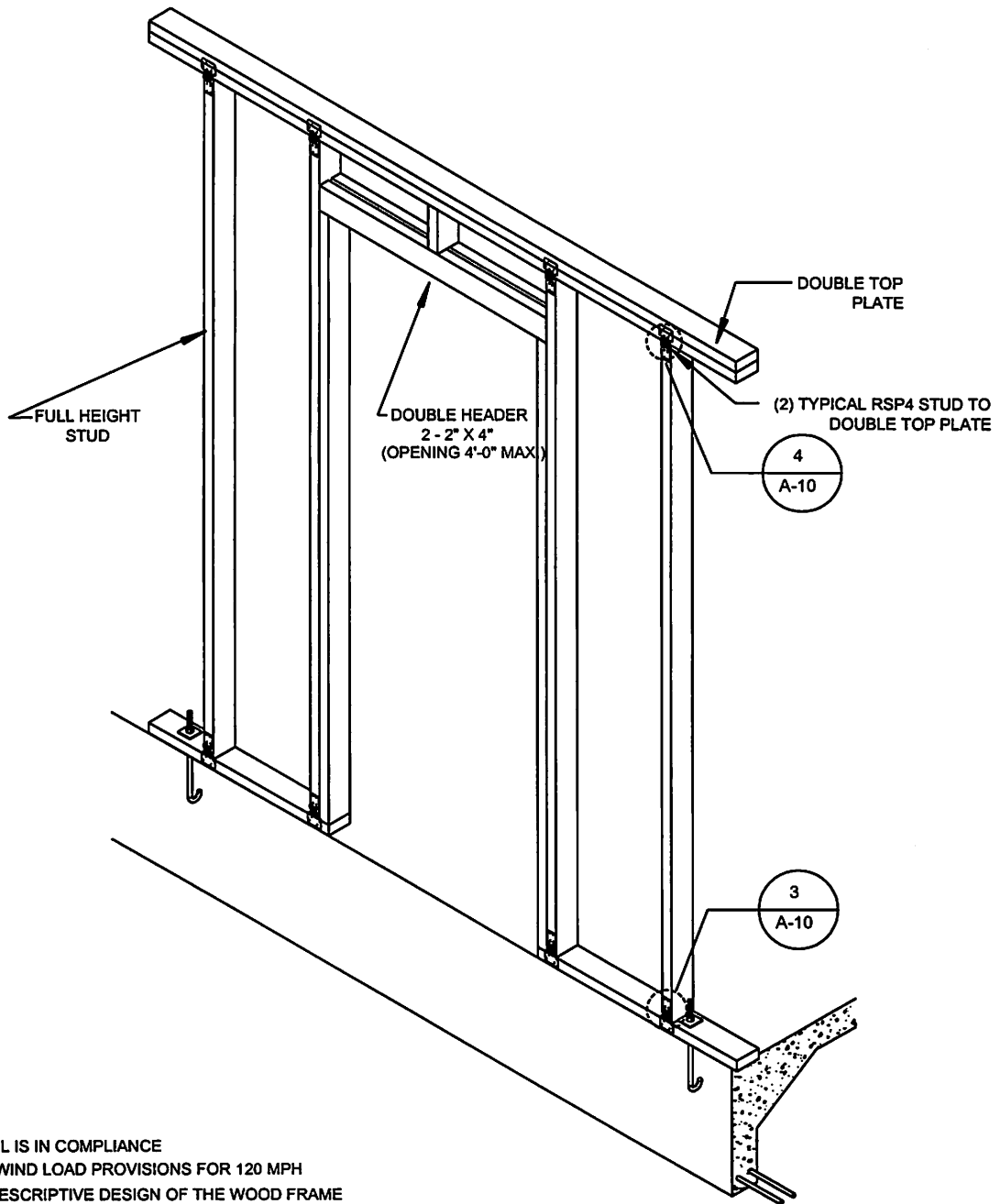

THIS DETAIL IS IN COMPLIANCE  
 WITH THE WIND LOAD PROVISIONS FOR 120 MPH  
 OF THE PRESCRIPTIVE DESIGN OF THE WOOD FRAME  
 CONSTRUCTION MANUAL (WFMC) 2001 EDITION

WOOD FRAMED  
 SHEDS

STANDARD DETAIL

FRAMING AT DOOR OPENING

DETAIL NUMBER:		A-8	
SPEC. NUMBER:		45MM	
SCALE:		3/8"=1'-0"	
DATE:	12/14/04	REVISION DATE:	3/15/05
DRAWN BY:	ANGEL	APPROVED BY:	

SIM 2  
1  
A-10

FULL HEIGHT  
STUD

DOUBLE HEADER  
2 - 2" X 4"  
(OPENING 4'-0" MAX.)

DOUBLE TOP  
PLATE

(2) TYPICAL RSP4  
STUD TO  
DOUBLE TOP  
PLATE

4  
A-10

(1) TYPICAL RSP4  
STUD TO SINGLE  
BOTTOM  
PLATE

3  
A-10

THIS DETAIL IS IN COMPLIANCE  
WITH THE WIND LOAD PROVISIONS FOR 120 MPH  
OF THE PRESCRIPTIVE DESIGN OF THE WOOD FRAME  
CONSTRUCTION MANUAL (WFMC) 2001 EDITION

WOOD FRAMED  
SHEDS

STANDARD DETAIL

FRAMING AT WINDOW OPENING  
SIDEWALL

DETAIL NUMBER:	A-9	
SPEC. NUMBER:	45MM	
SCALE:	3/8"=1'-0"	
DATE:	12/14/04	REVISION DATE:
DRAWN BY:	ANGEL	APPROVED BY:

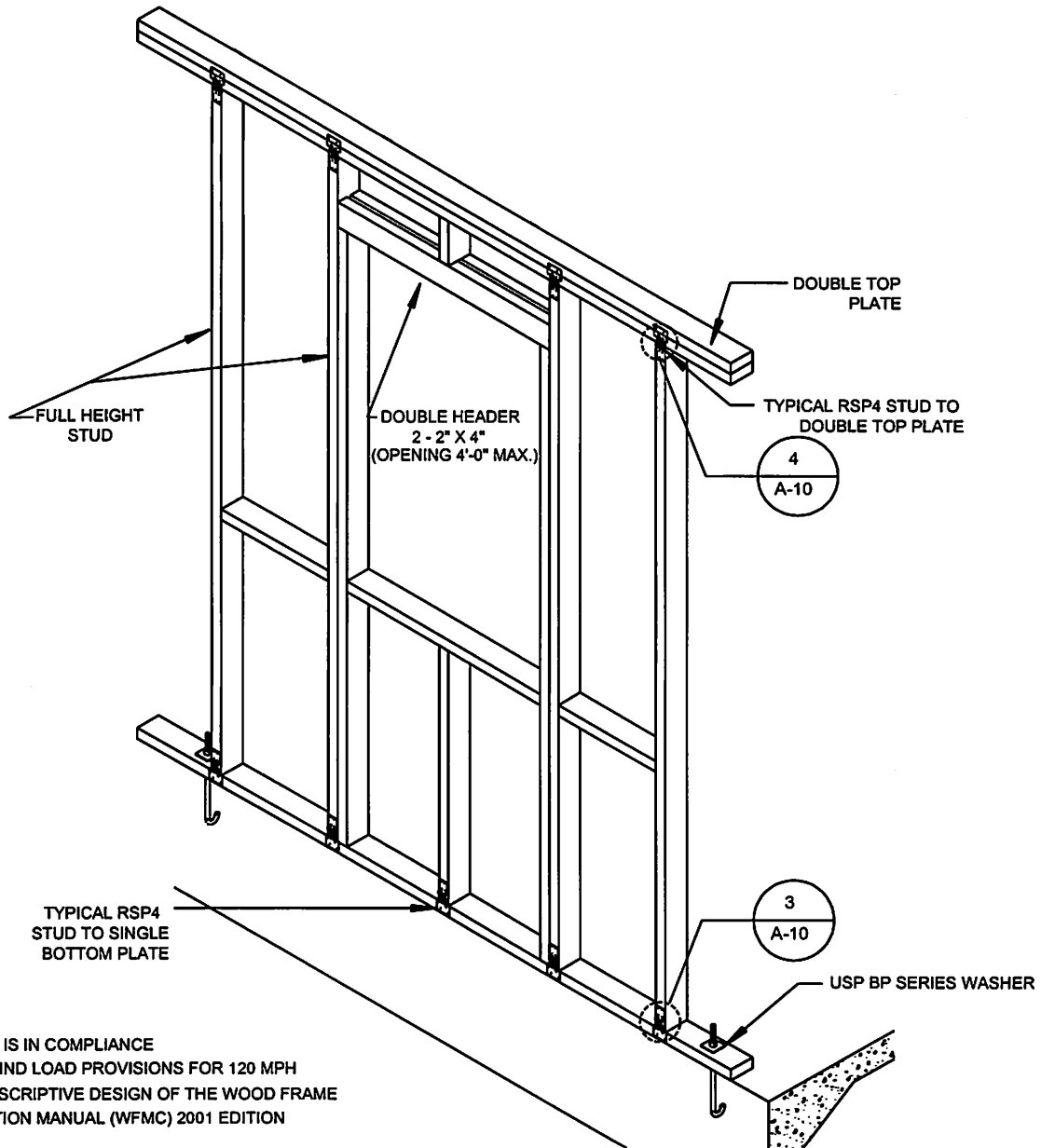

THIS DETAIL IS IN COMPLIANCE  
 WITH THE WIND LOAD PROVISIONS FOR 120 MPH  
 OF THE PRESCRIPTIVE DESIGN OF THE WOOD FRAME  
 CONSTRUCTION MANUAL (WFMC) 2001 EDITION

WOOD FRAMED  
 SHEDS

STANDARD DETAIL

FRAMING AT WINDOW OPENING  
 ENDWALL

DETAIL NUMBER:		A-10	
SPEC. NUMBER:		45MM	
SCALE:		3/8"=1'-0"	
DATE:	12/14/04	REVISION DATE:	3/15/05
DRAWN BY:	ANGEL	APPROVED BY:	

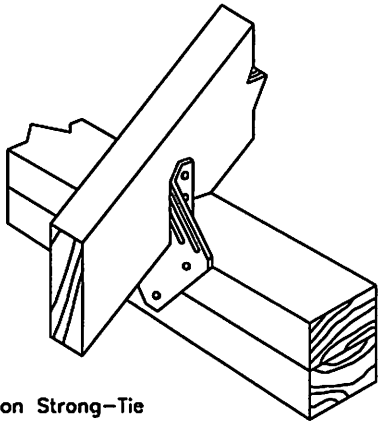

Simpson Strong-Tie  
H1  
10 FASTENERS 8d COMMON NAILS

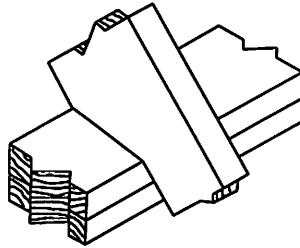

RAFTERS NOTCHED AT  
TOP PLATE (BIRD MOUTH CUT)  
2 A-10 N.T.S.

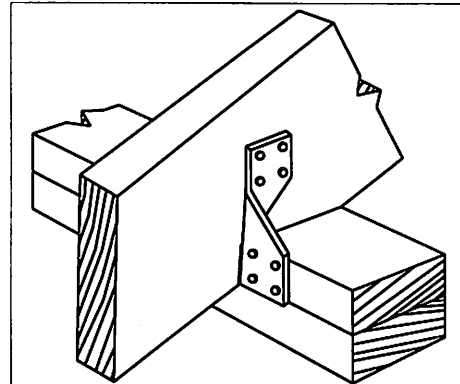

Simpson Strong-Tie  
H3  
8 FASTENERS 8d COMMON NAILS

3 (H3) ROOF DETAIL  
A-10 N.T.S.

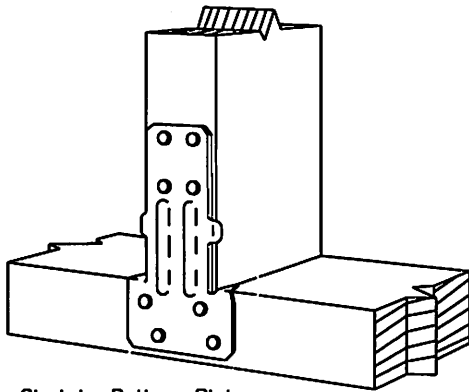

Stud to Bottom Plate  
Simpson Strong-Tie  
RSP4  
8 FASTENERS 8d COMMON NAILS

4 (1) TYPICAL RSP4  
STUD SINGLE BOTTOM PLATE  
A-10 N.T.S.

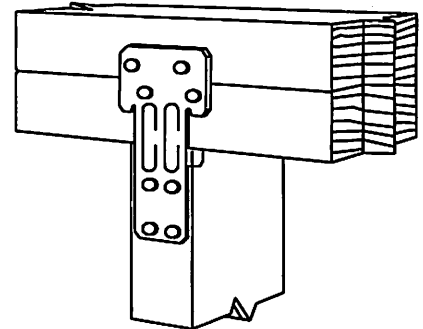

Stud to Double Top Plates  
Simpson Strong-Tie  
RSP4  
8 FASTENERS 8d COMMON NAILS

5 (2) TYPICAL RSP4  
STUD TO DOUBLE TOP PLATE  
A-10 N.T.S.

THIS DETAIL IS IN COMPLIANCE  
WITH THE WIND LOAD PROVISIONS FOR 120 MPH  
OF THE PRESCRIPTIVE DESIGN OF THE WOOD FRAME  
CONSTRUCTION MANUAL (WFMC) 2001 EDITION

WOOD FRAMED  
SHEDS

STANDARD DETAIL

CONNECTOR DETAILS

DETAIL NUMBER:		A-11	
SPEC. NUMBER:		45MM	
SCALE:		N.T.S.	
DATE:	12/14/04	REVISION DATE:	3/15/05
DRAWN BY:	ANGEL	APPROVED BY:	

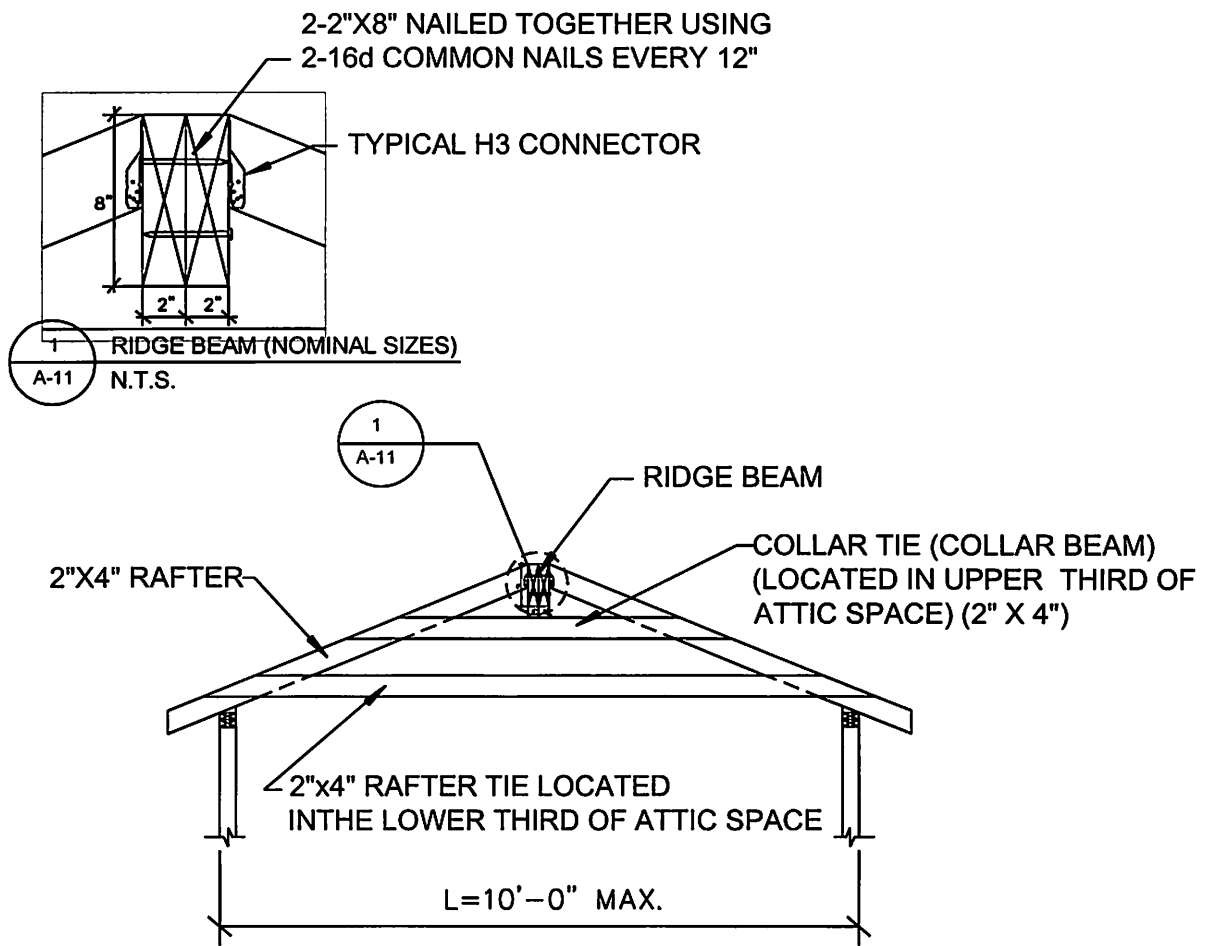

THIS DETAIL IS IN COMPLIANCE  
WITH THE WIND LOAD PROVISIONS FOR 120 MPH  
OF THE PRESCRIPTIVE DESIGN OF THE WOOD FRAME  
CONSTRUCTION MANUAL (WFMC) 2001 EDITION

WOOD FRAMED  
SHEDS

STANDARD DETAIL

RIDGE BEAM AND  
COLLAR TIE DETAIL

DETAIL NUMBER:		A-12	
SPEC. NUMBER:		45MM	
SCALE:		3/8"=1'-0"	
DATE:	12/14/04	REVISION DATE:	3/15/05
DRAWN BY:	ANGEL	APPROVED BY:	

8d COMMON NAILS  
OR  
10d BOX NAILS

6" O.C. AT EDGES  
12" O.C. INTERMEDIATE

RAFTERS 16" O.C.

ROOF SHEATHING

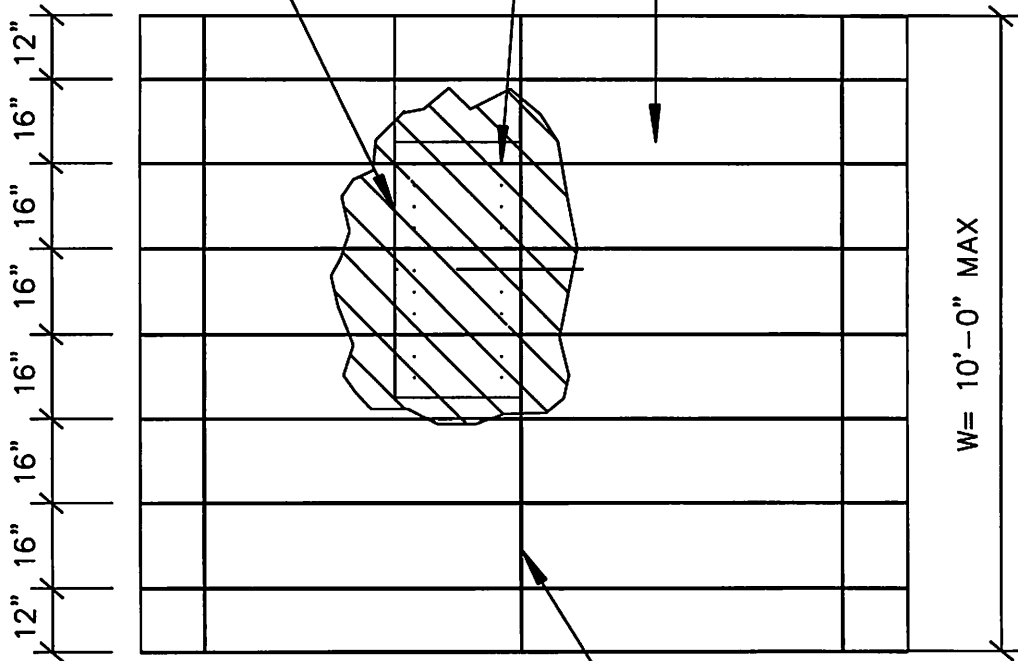

L = 10'-0" MAX

W = 10'-0" MAX

— RIDGE BOARD

THIS DETAIL IS IN COMPLIANCE  
WITH THE WIND LOAD PROVISIONS FOR 120 MPH  
OF THE PRESCRIPTIVE DESIGN OF THE WOOD FRAME  
CONSTRUCTION MANUAL (WFMC) 2001 EDITION

WOOD FRAMED  
SHEDS

STANDARD DETAIL  
ROOF FRAMING PLAN

DETAIL NUMBER:		A-13	
SPEC. NUMBER:		45MM	
SCALE:		3/8" = 1'-0"	
DATE:	12/14/04	REVISION DATE:	3/15/05
DRAWN BY:	ANGEL	APPROVED BY:	

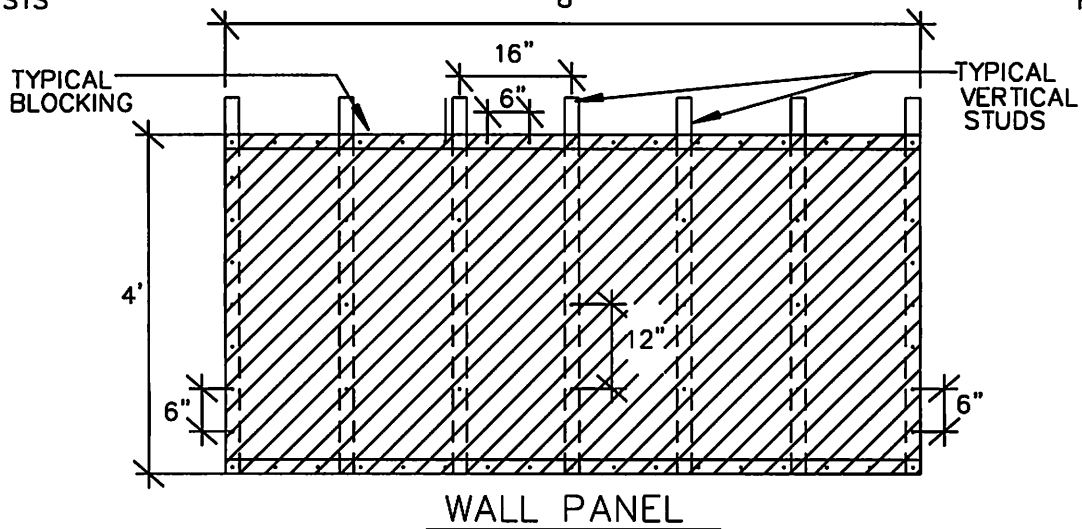
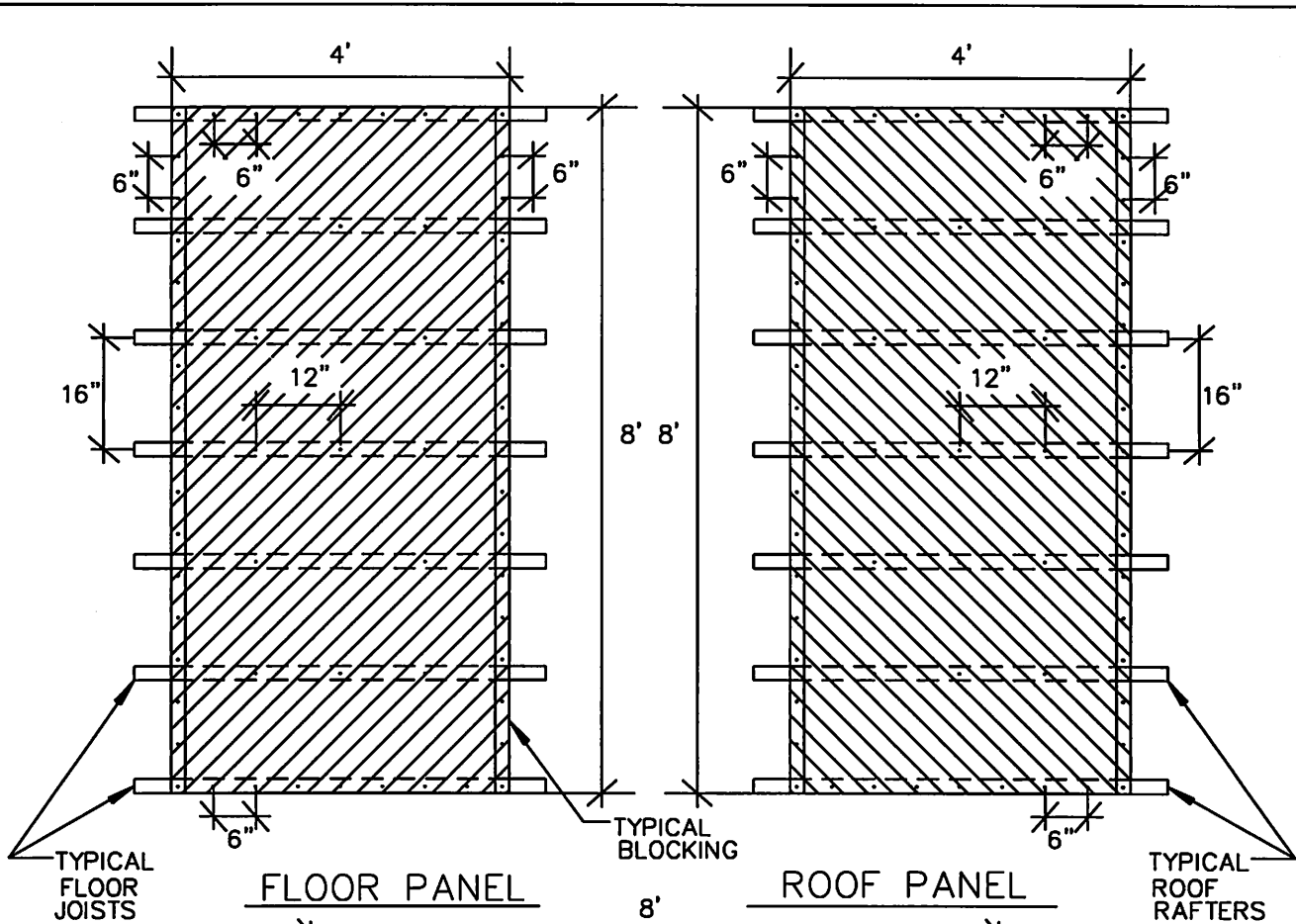

WOOD FRAMED  
SHEDS

NAILING PATTERN

WOOD STRUCTURAL PANELS

DETAIL NUMBER:	A-14	
SPEC. NUMBER:	45MM	
SCALE:	3/8"=1'-0"	
DATE:	12/14/04	REVISION DATE:
DRAWN BY:	ANGEL	APPROVED BY: